



Old Courthouse Phase 2
Renovation
Gateway Arch National Park

GANP – 242900/253127
(formerly JEFF 199879)





Old Courthouse Phase 2 Renovation, Gateway Arch National Park

- Brief Description

Installation of a new interior elevator, family restrooms, floor ramps, interior wayfinding signage, replacement of existing steam radiator system with new 4-pipe mechanical system, new fire-sprinkler system with detectors and alarms, upgrades to lighting, power, security and IT infrastructure, structural floor reinforcement, and replacement of window sashes and repair/refurbishment of window frames. Demolition, abatement and remediation of lead paint and asbestos.

- Location: St. Louis, Missouri
- Estimated Price: \$10M - \$20M





Old Courthouse Phase 2 Renovation, Gateway Arch National Park

- Design & Construction Method
Design – Bid - Build
- Procurement Method:
Full & Open Competition
- Schedule (Approximate):
Solicitation Date: July 2022
Award Date: August/Sept 2022
Period of Performance: Winter
2022/2023 – Spring 2024

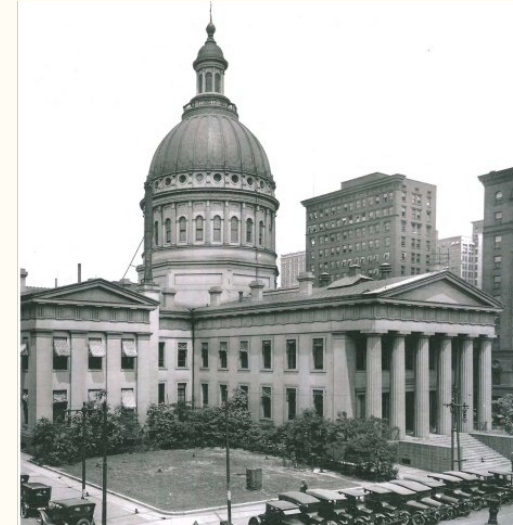
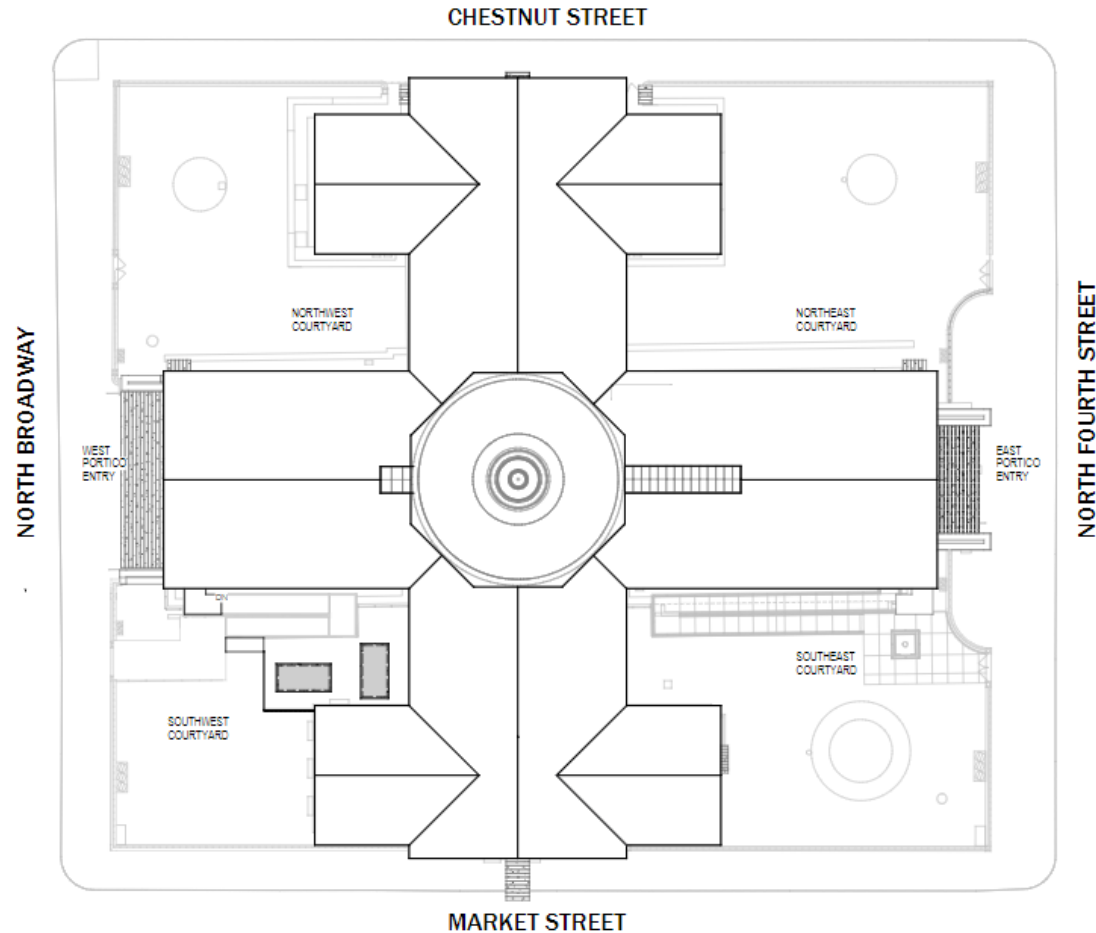



Old Courthouse Phase 2 Renovation, Gateway Arch National Park

- Performance Constraints & Other Considerations
 - Working within an historic building and the challenges of unforeseen conditions
 - Rehabilitation, restoration or replacement of historic features while demonstrating compliance with Secretary of the Interior’s Standards for Historic Preservation
 - Replacement of 40-year old wood windows within existing openings
 - Updating HVAC, fire suppression and electrical systems
 - Accessibility Improvements

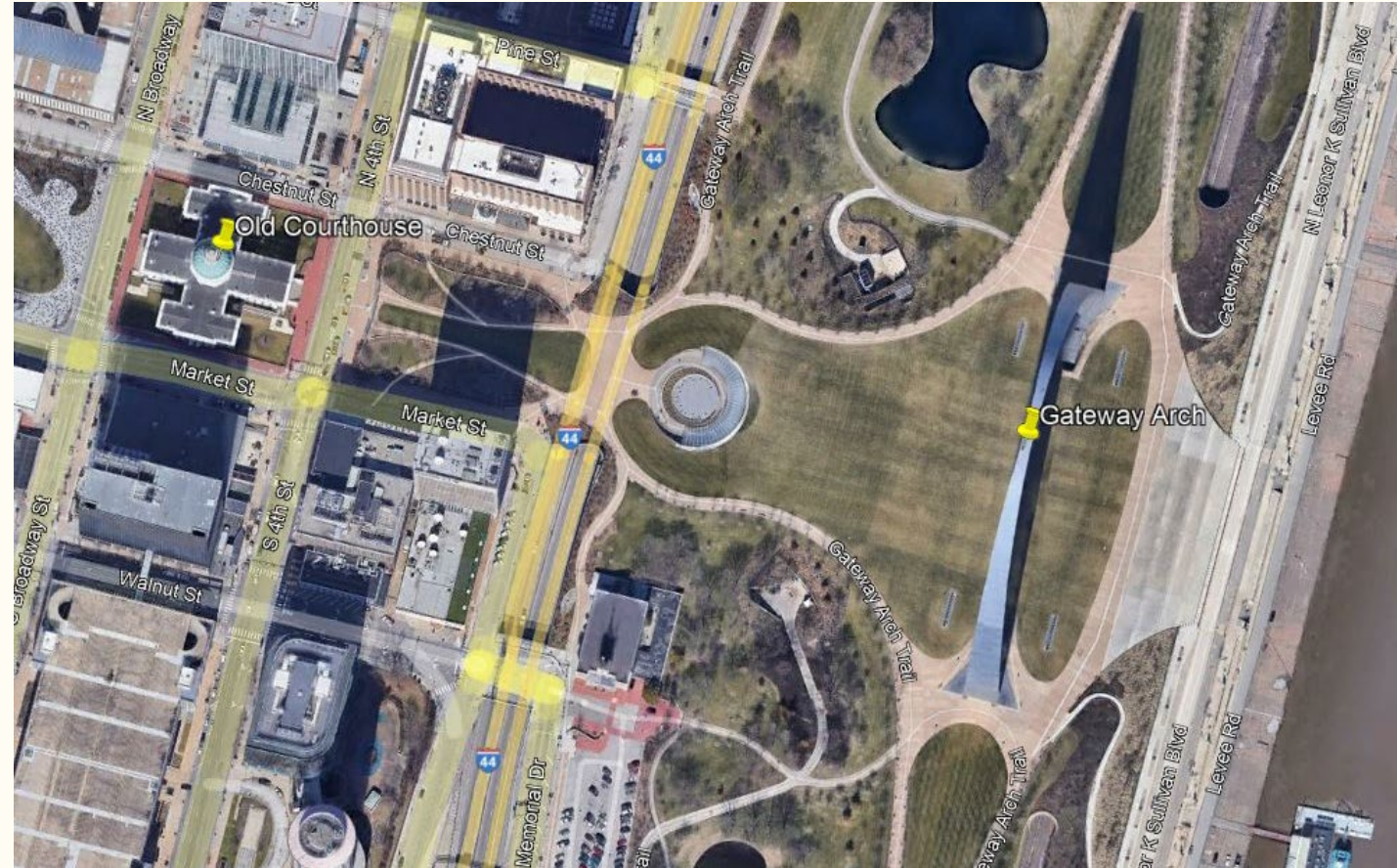



Old Courthouse Phase 2 Renovation, Gateway Arch National Park

- Performance Constraints & Other Considerations
 - Logistics and coordination of trades
 - Worker Safety
 - Hazardous materials removal
 - Urban work environment

